

# Madaba 'O

---

Hotel, Resort, SPA & Campus

*Project leaders:*

**Carlo Maria Grassi**  
**Nunzio Gabriele Sciveres**

*Design team:*

Giulia Dozzio Cagnoni  
Sara Gangemi  
Giuseppe Gurrieri  
Francesco Librizzi  
Eugenio Morello

*Collaborators:*

Piergiorgio Italiano  
Zulfadly Helmy Bin Ab Wahid

# CONCEPT

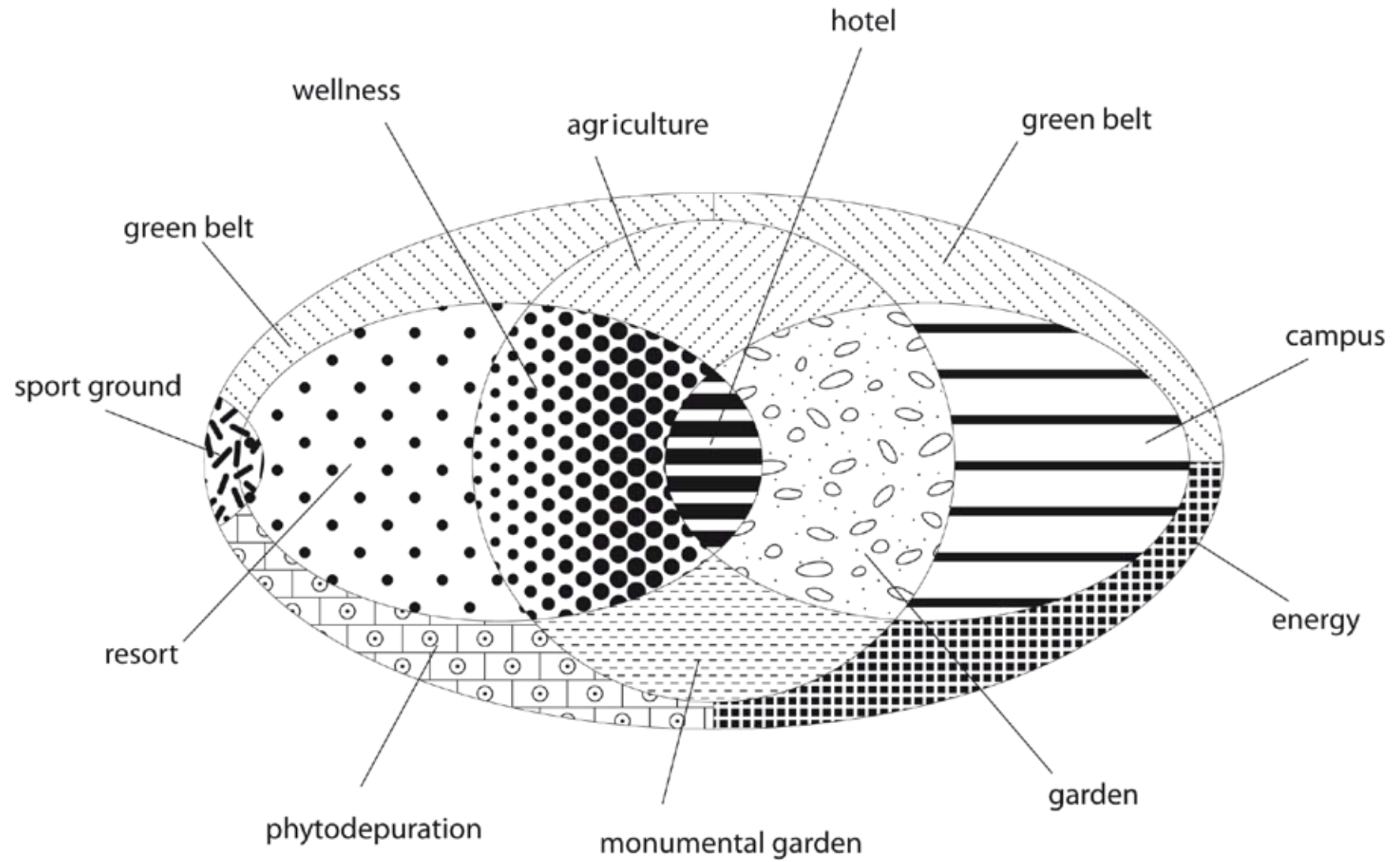

# ENVIROMENTAL AND ENERGY STRATEGIES

## SUN

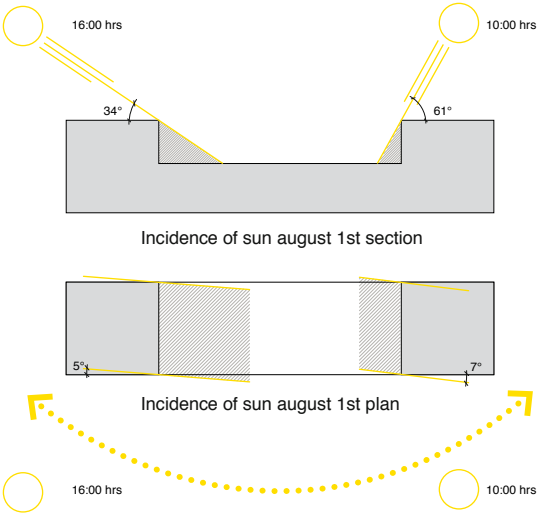
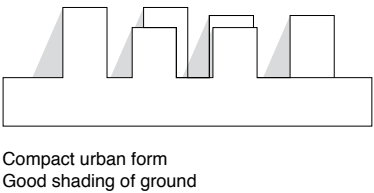
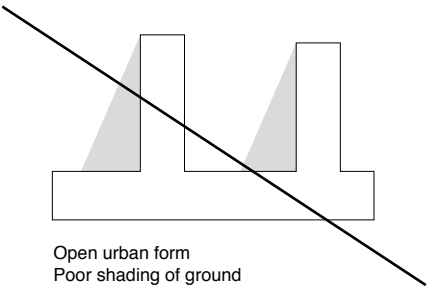

## WIND

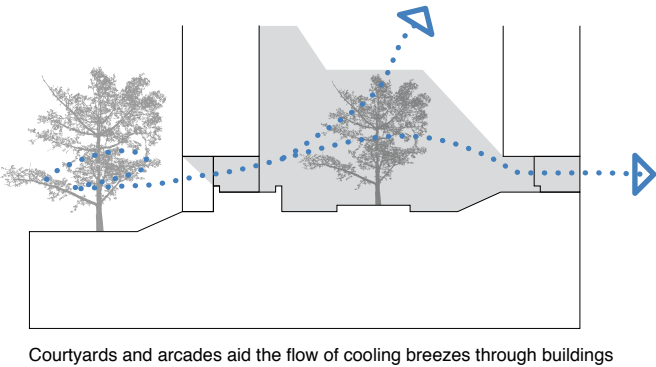
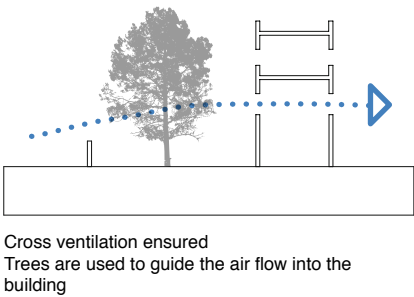
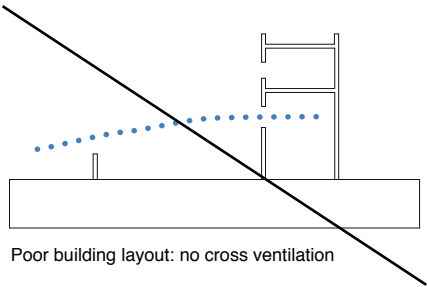

## WATER

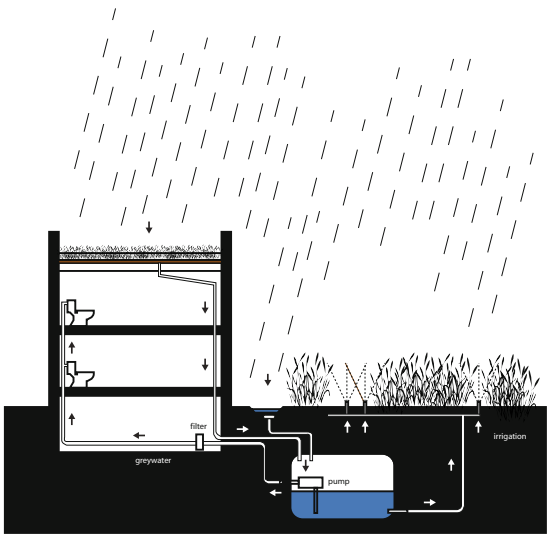

# SOCIAL STRATEGIES

## SOCIAL ASPECTS

The architectural and urban design strategies invest also the social aspects and social behavior of people in space and time. Guests and students have different backgrounds and cultural habits and we should consider all those traditions at the same time.

The privacy design happens at very different scales:

- At the small scale, different types of Mashrabiya provide an efficient and traditional solution to assure a control of the visibility between indoor and outdoor spaces.
- At the medium scale, the privacy of private spaces (guest rooms) towards public spaces is obtained by the proper arrangement of buildings (relationship window and open spaces), shelters and walls.
- At the large scale, it is very important to define the accessibility of different functions by distinguishing public, semi-public and private spaces. Gender issues have also to be taken into account in the dorms.

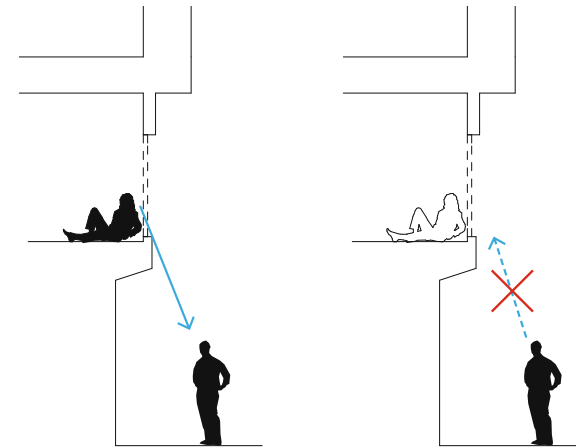

Open and closed vision to provide privacy (Mashrabiya)



Different types of Mashrabiya

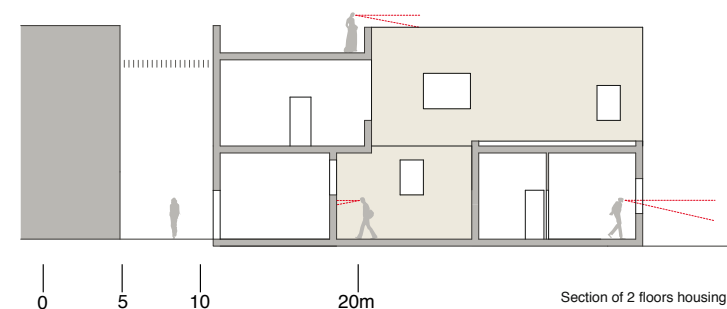
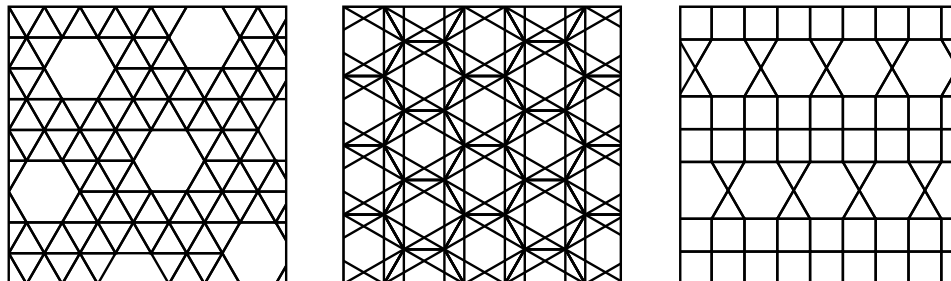

Section of 2 floors housing



# MASTERPLAN

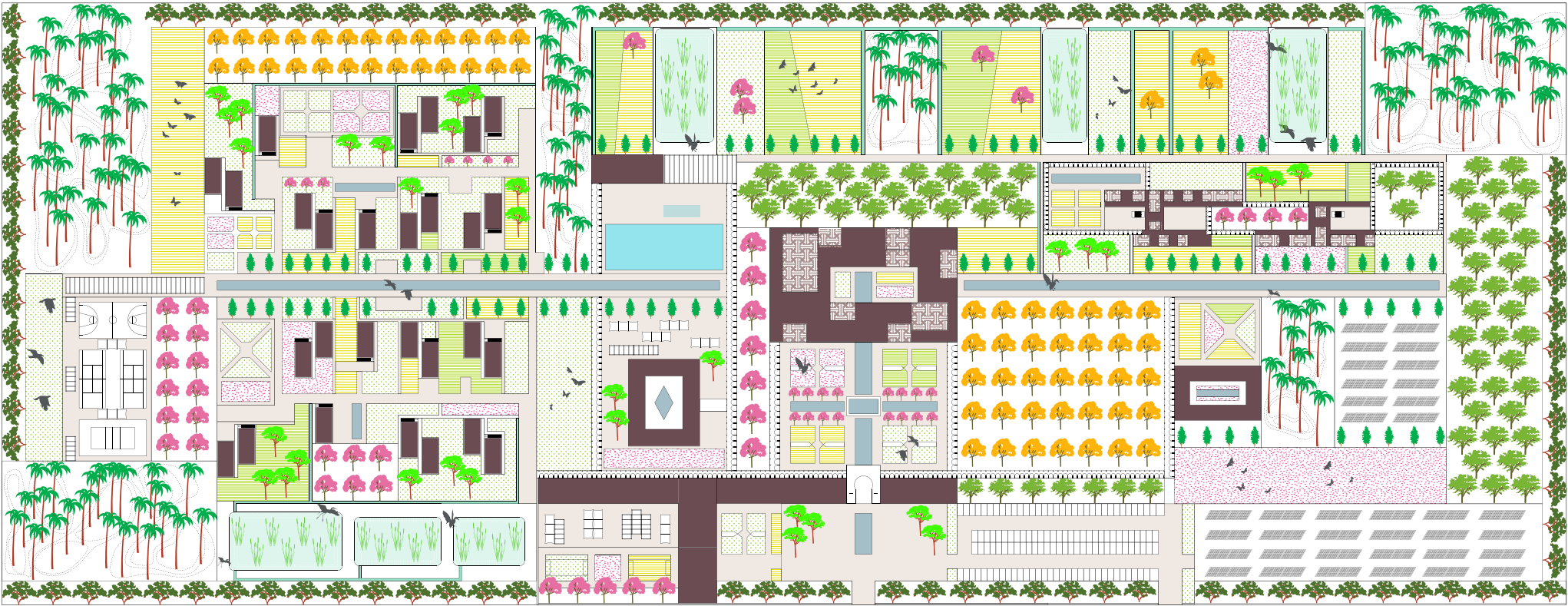

BUILDING

- hotel
- resort
- hotel management school
- accueil
- restaurant
- auditorium

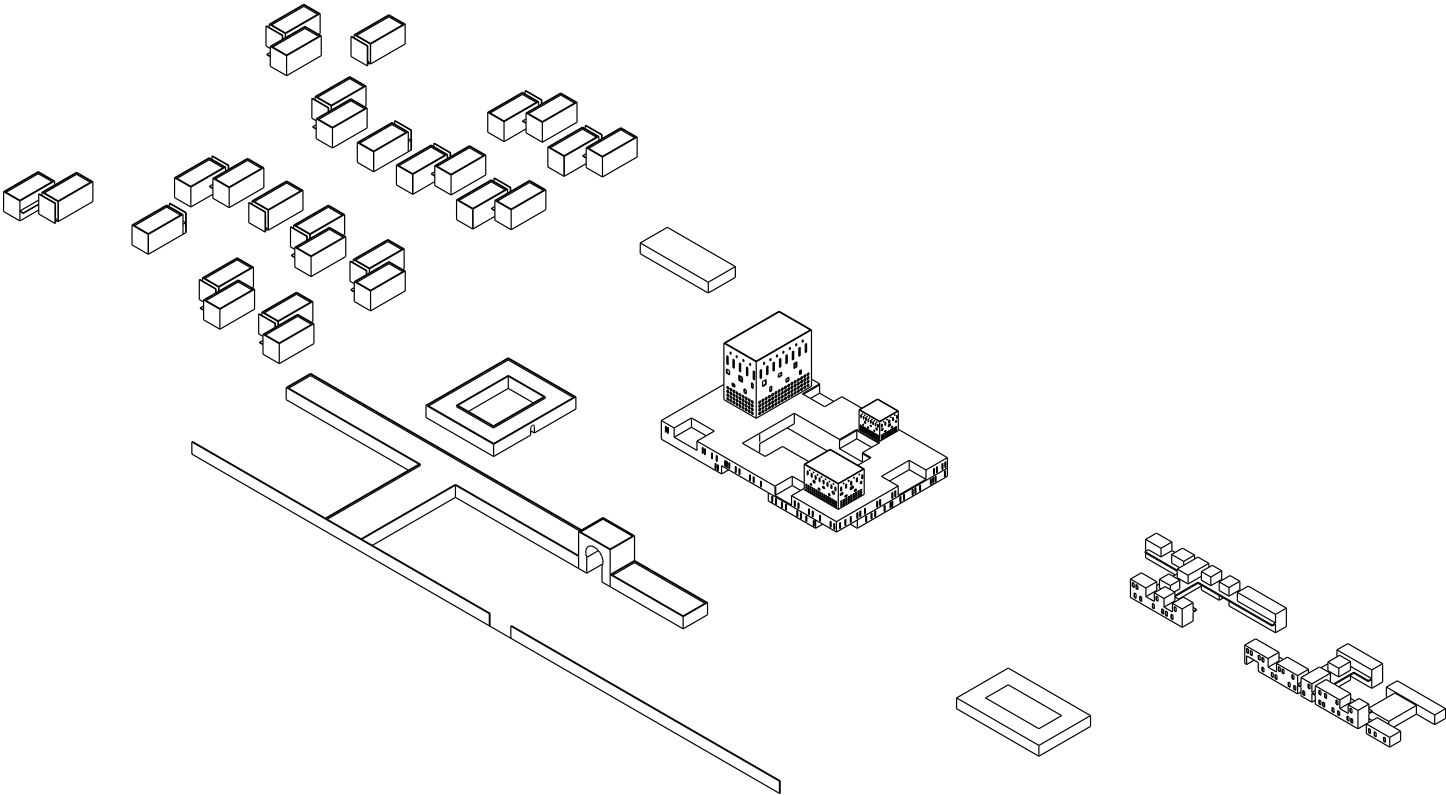

# WATER AND ENERGY SCAPE

solar thermal panels  
pv panels  
phytodepuration

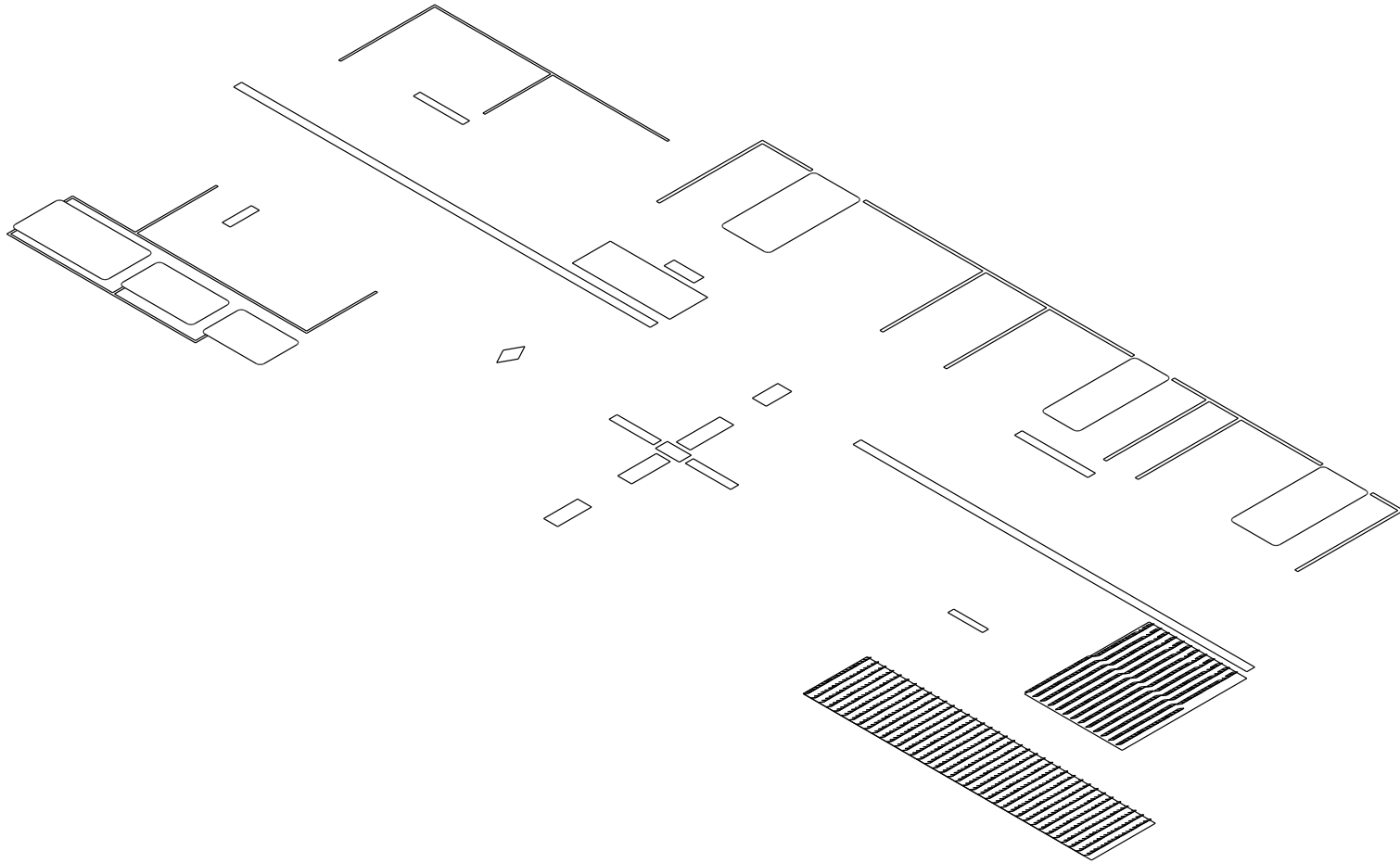

TREES

- green belt
- palm groves
- cypress roads
- orchards

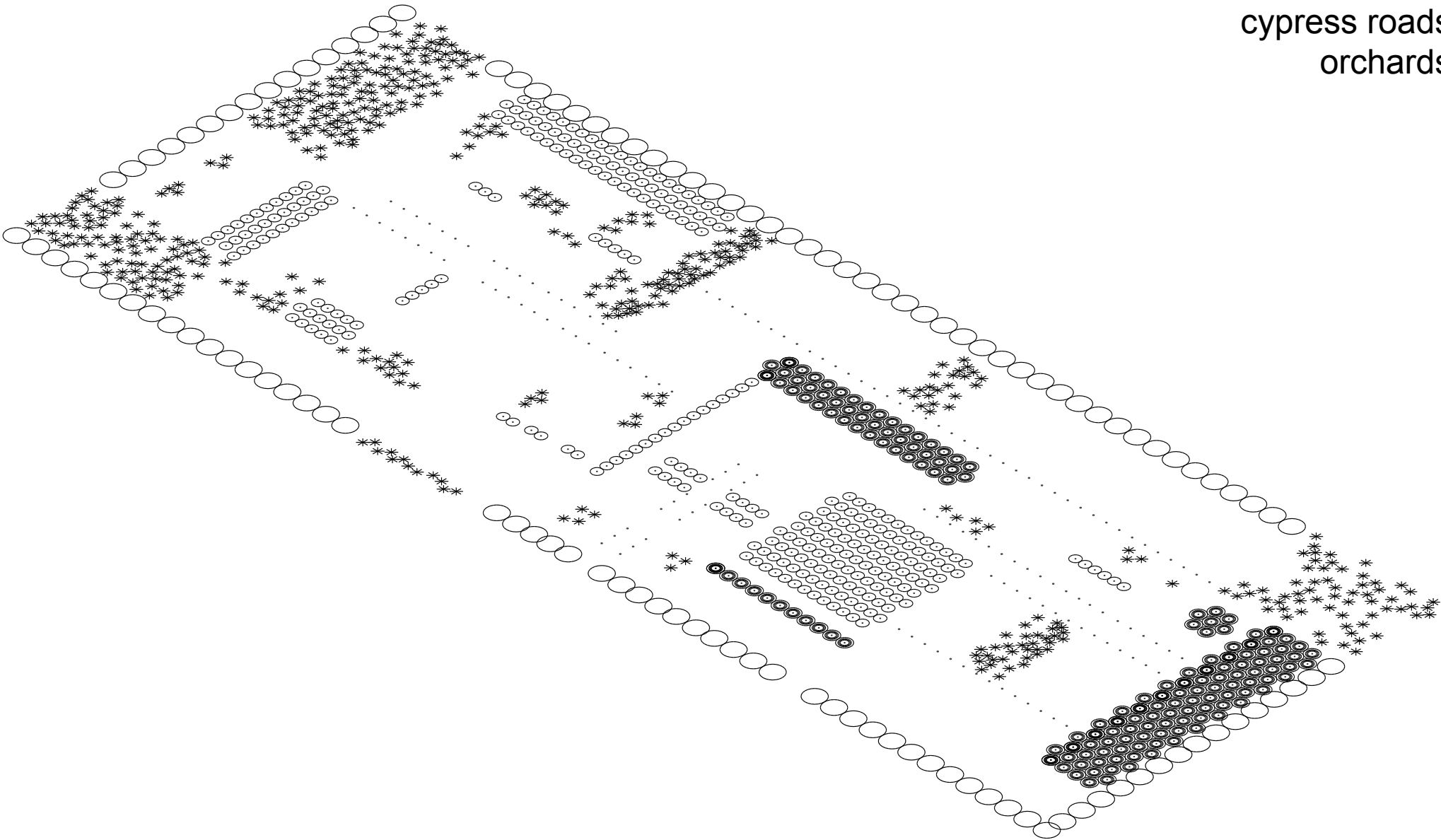

# SOFTSCAPE

fresh gardens  
food production  
bushes

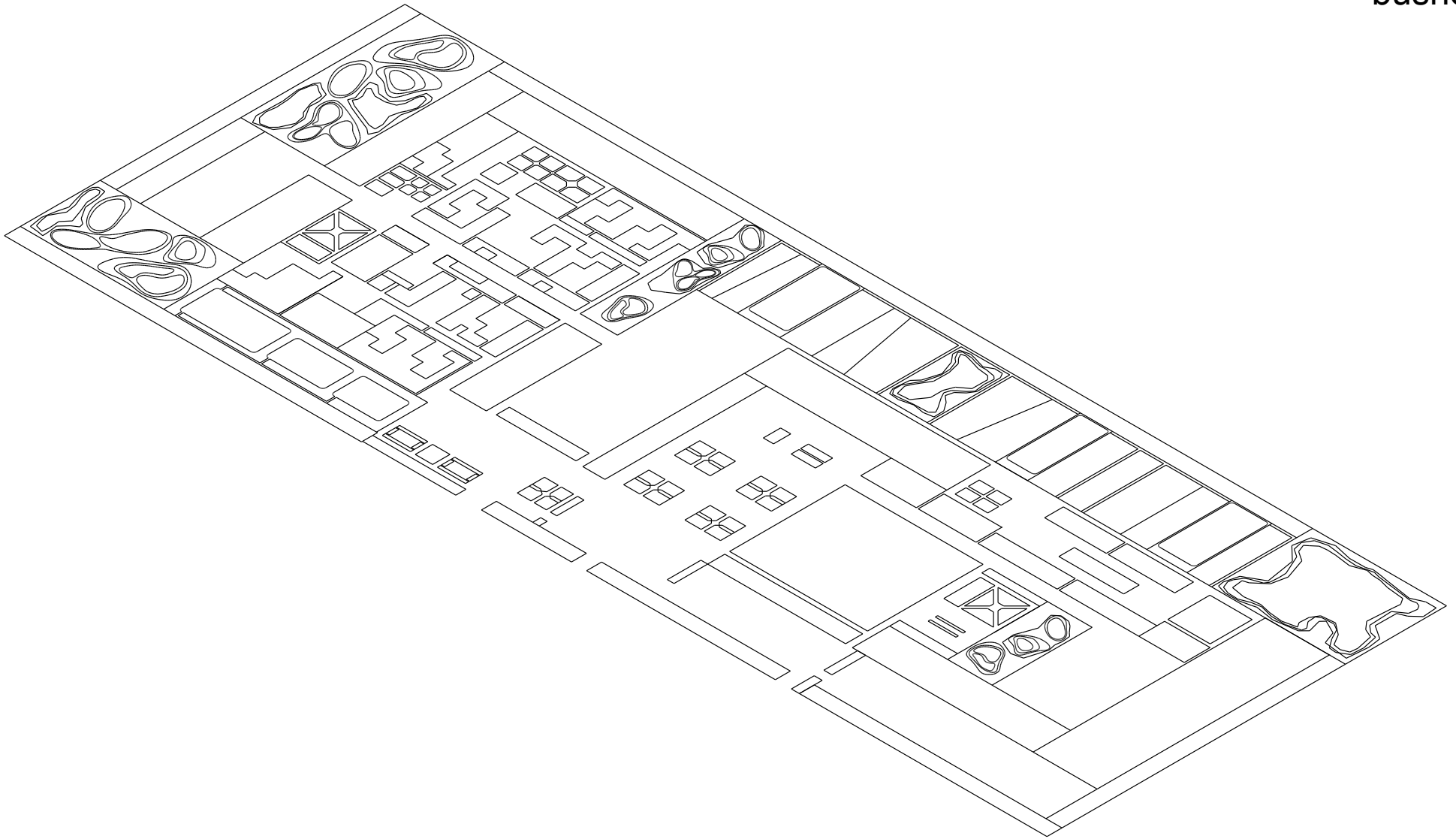

AXONOMETRIC VIEW

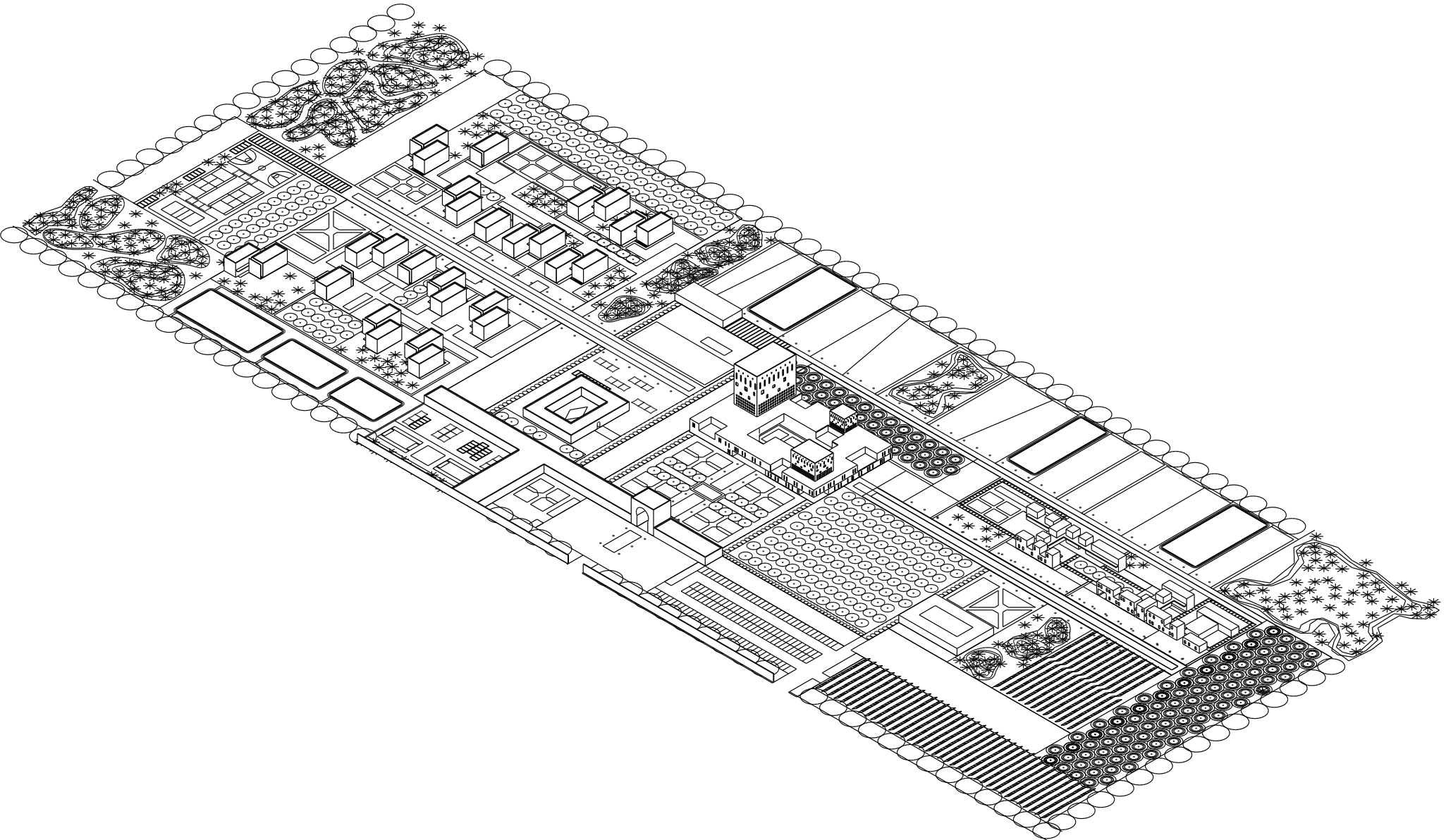

# ACTIVITIES

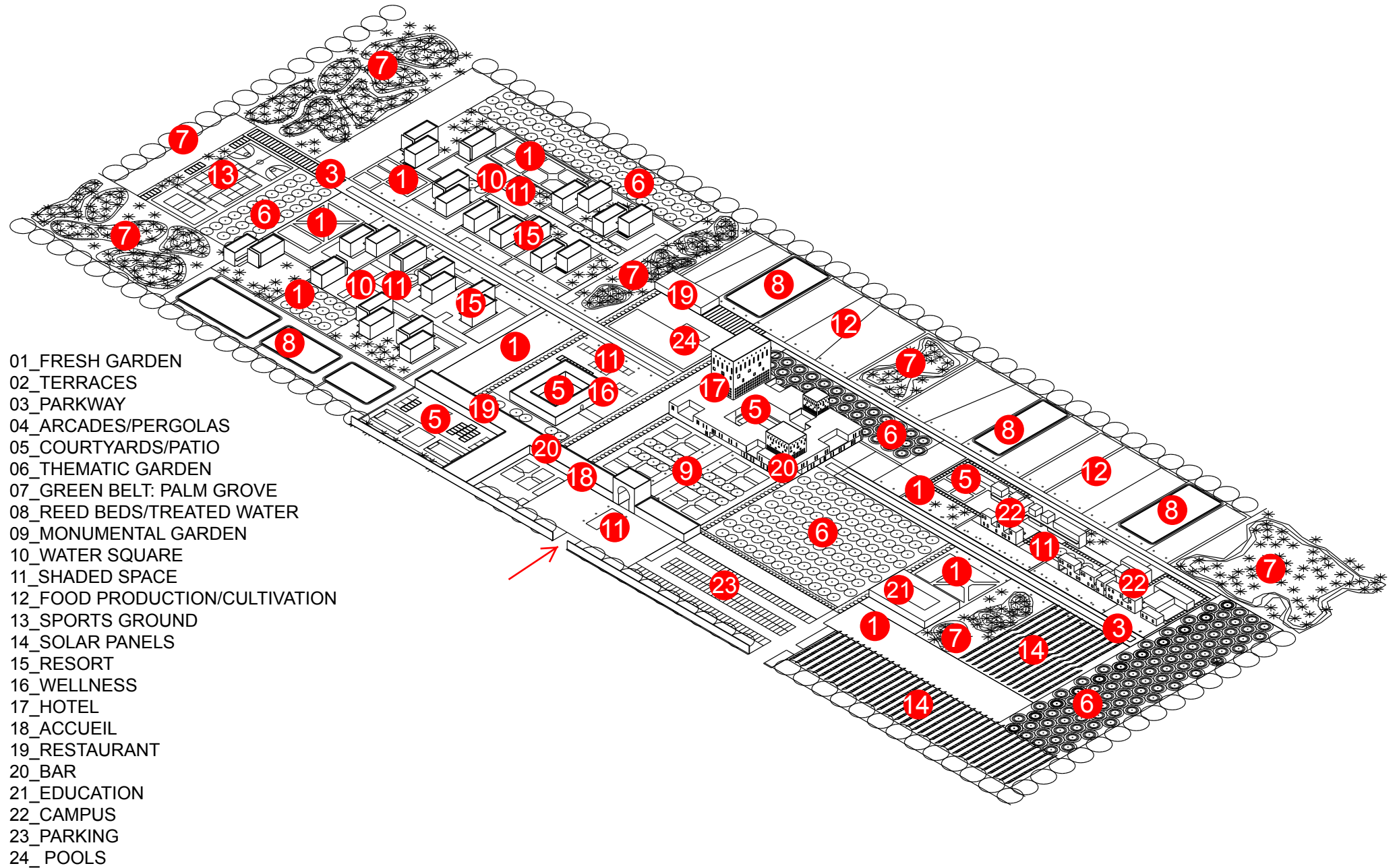



# TYPESLOGIES open space

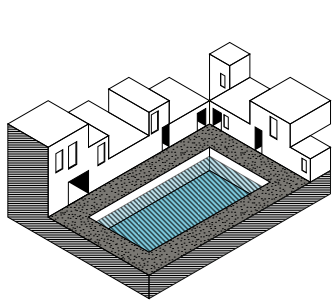

PUBLIC SPACE : WATER SQUARE

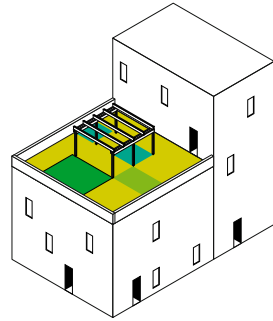

TERRACE

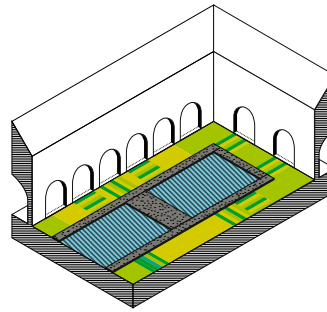

COURTYARD / PATIO

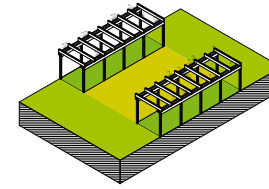

ARCADE / PERGOLA

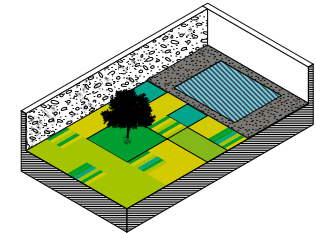

THEMATIC GARDEN : FRESH GARDEN

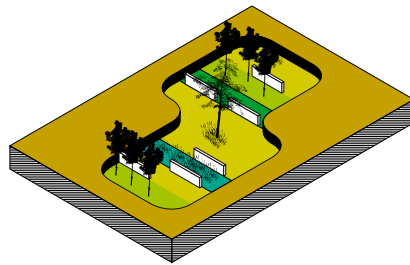

FOOD PRODUCTION / CULTIVATION

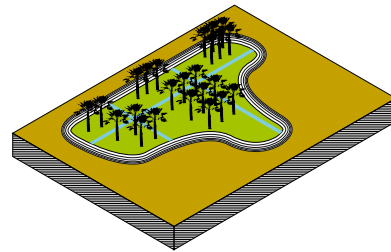

GREEN BELT : PALM GROVE

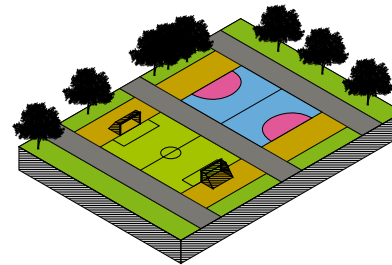

SPORTS GROUND

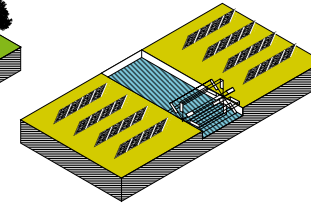

ENERGETIC SCAPE

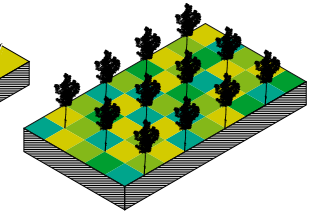

THEMATIC GARDEN : ORCHARD

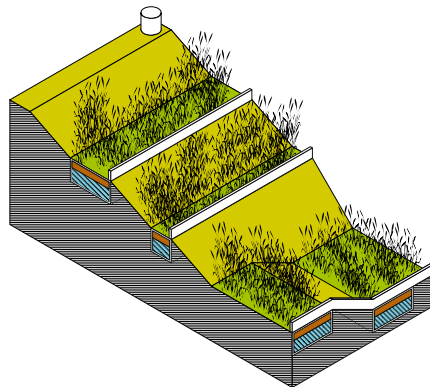

REED BEDS / TREATED WATER

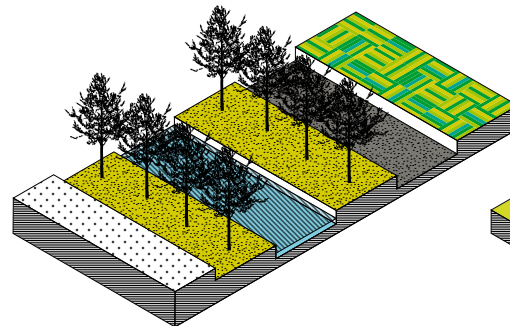

PARKWAY

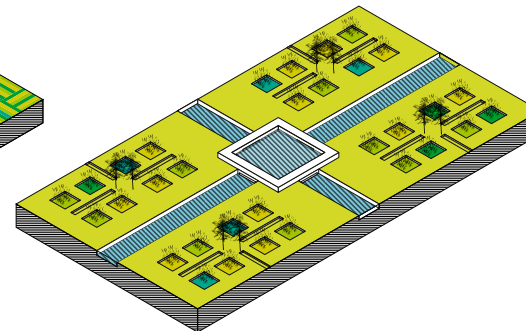

PUBLIC SPACE : MONUMENTAL GARDEN

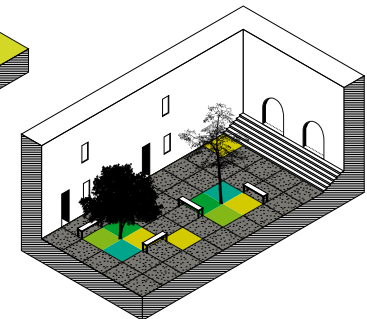

PUBLIC SPACE : SHADED SPACE



**TYPOLOGIES built space: HOTEL 4 stars**

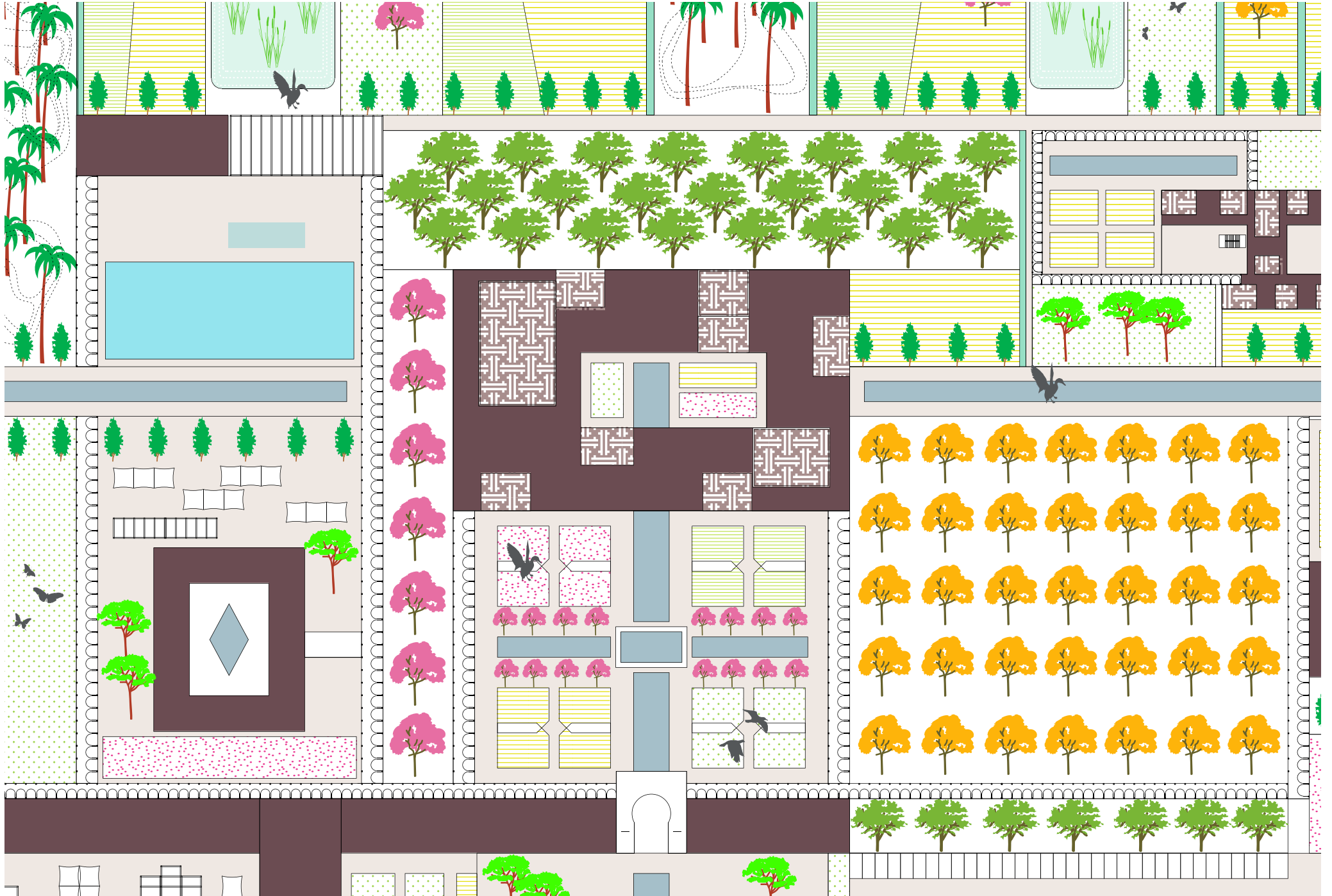

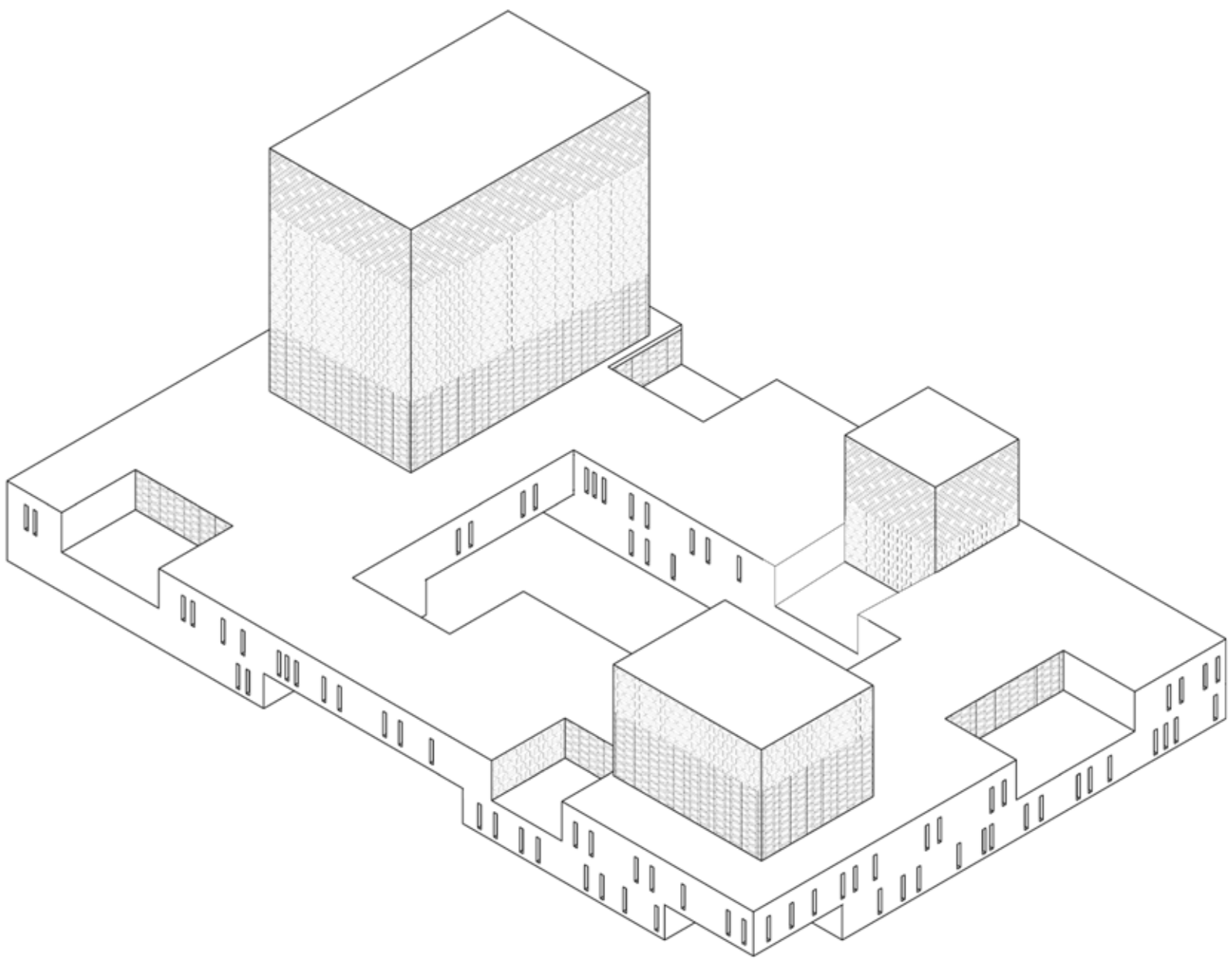



reception  
38 standard rooms  
1 standard suite  
wellness center  
shop  
lobby lounge  
lobby bar

GROUND FLOOR PLAN

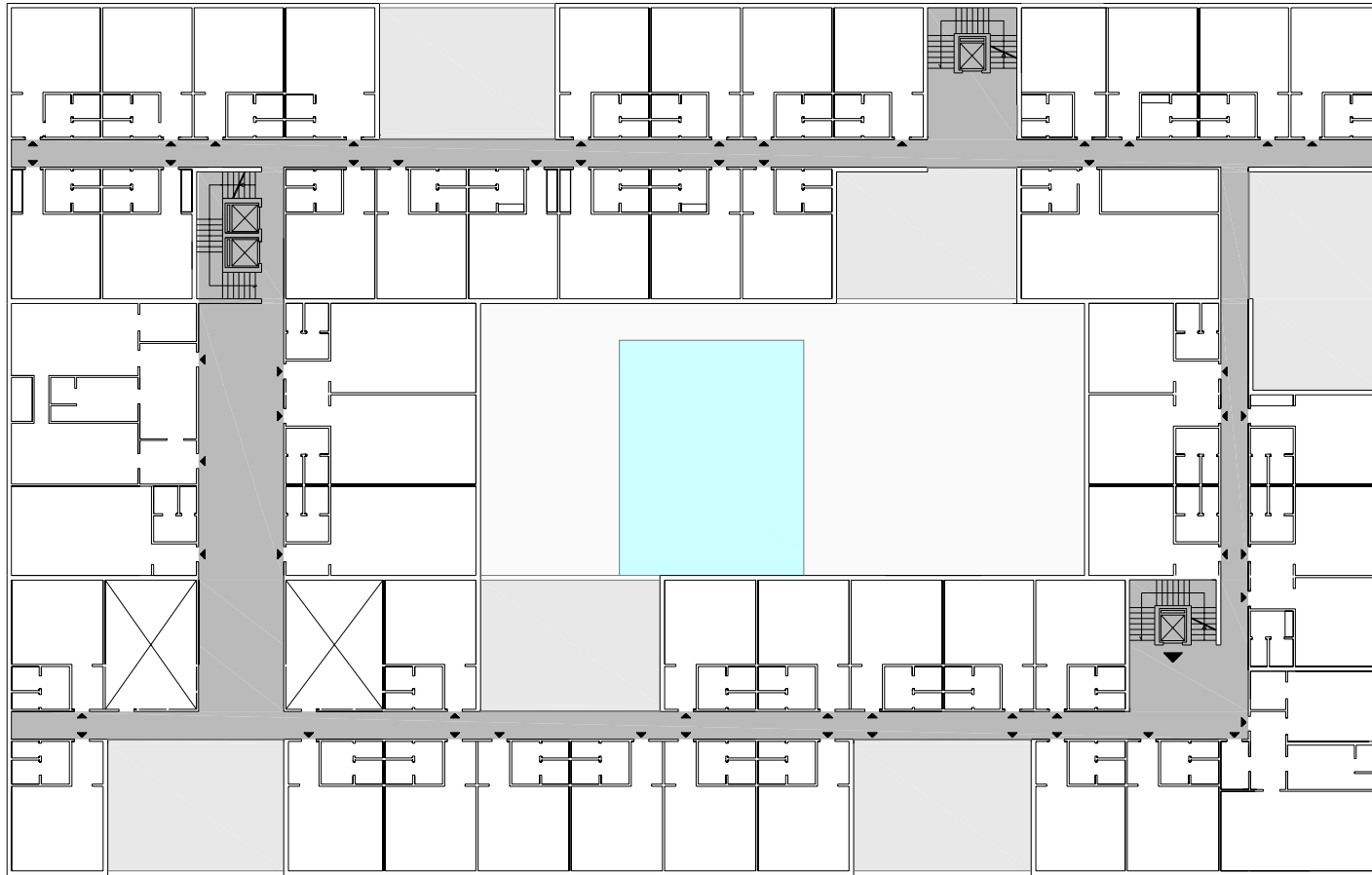

45 standard rooms  
2 club suite  
1 standard suite  
5 solarium terrace

1st FLOOR PLAN

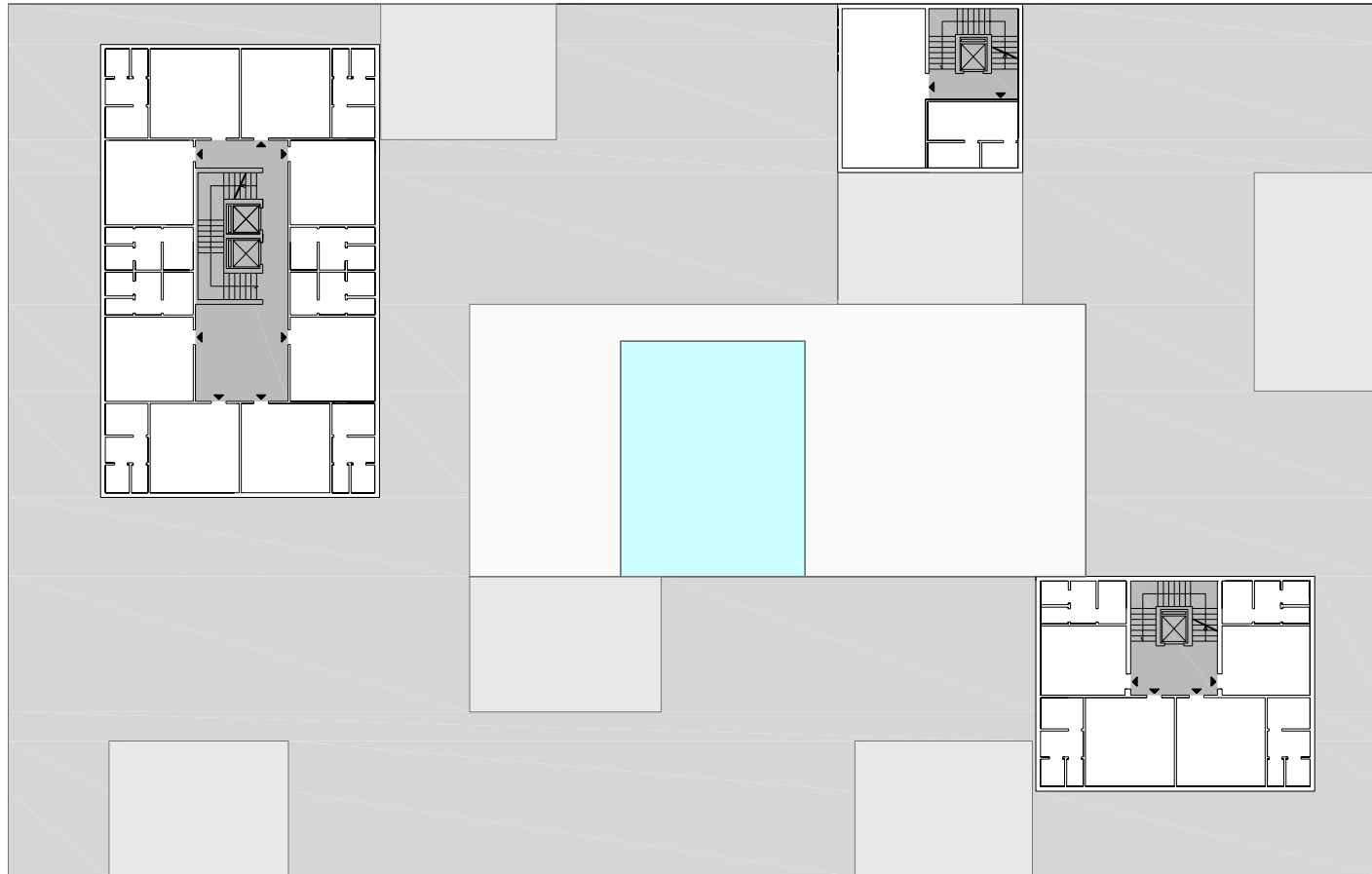

TOWER 1 six floors  
48 standard rooms  
1 solarium terrace  
1 roof top Speciality  
restaurant

TOWER 2 two floors  
2 suite

TOWER 3 three floors  
12 standard rooms

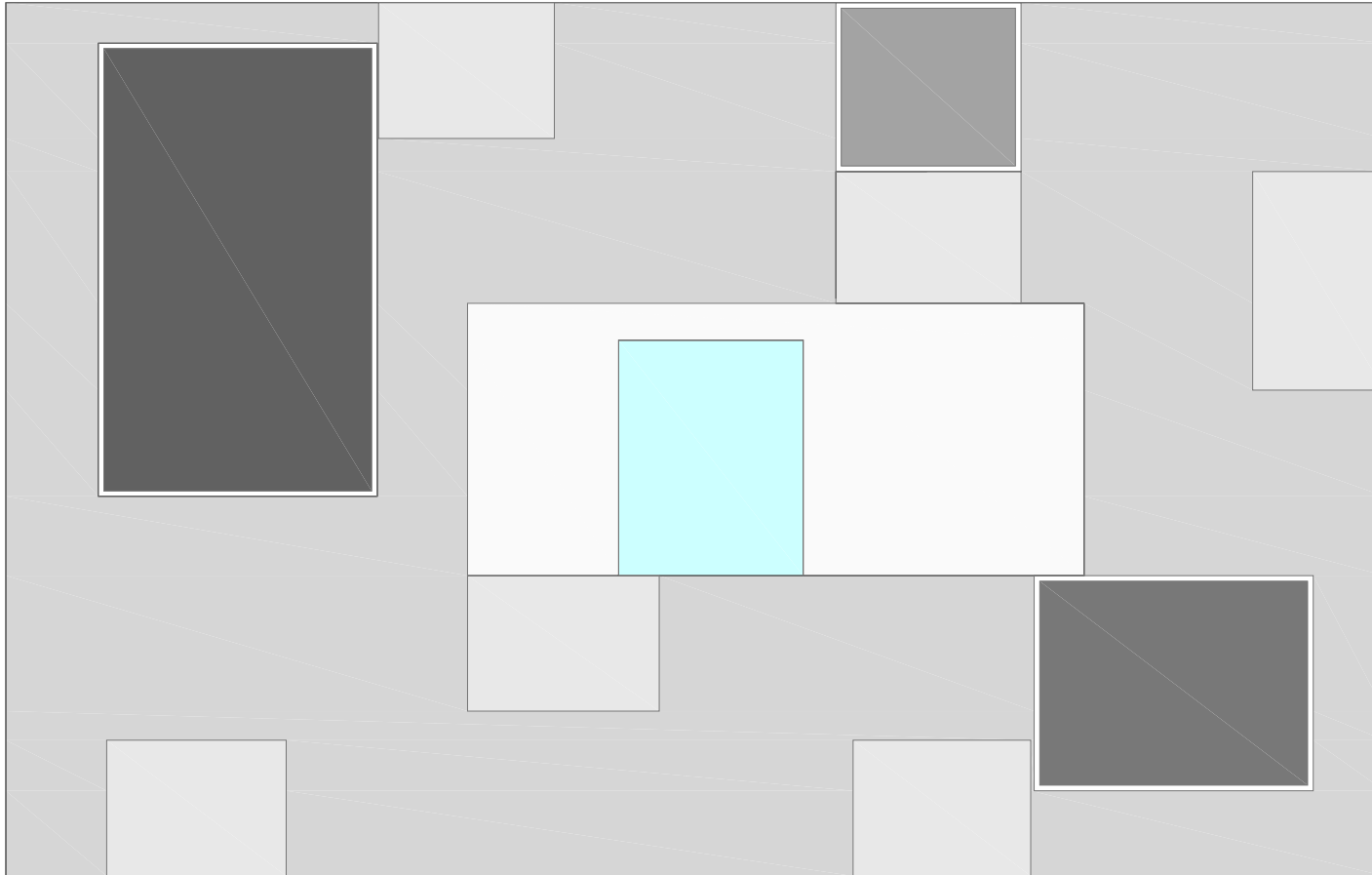

ROOFING PLAN

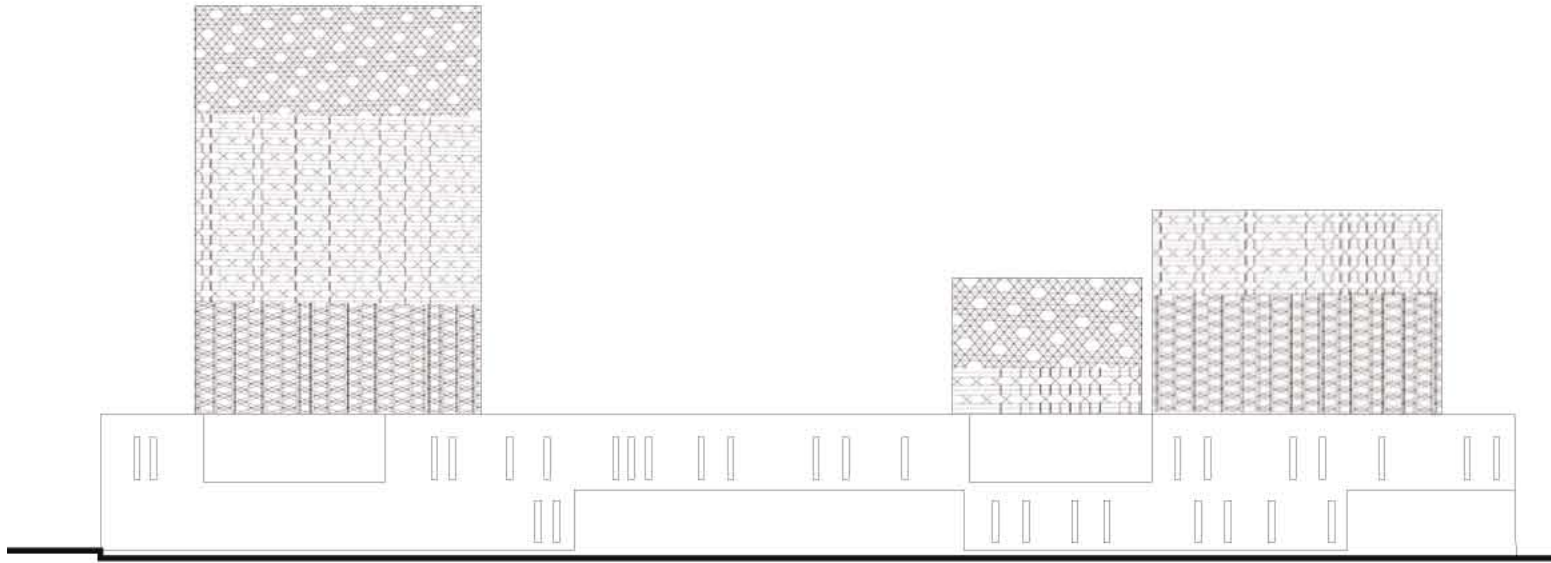

MAIN ELEVATION

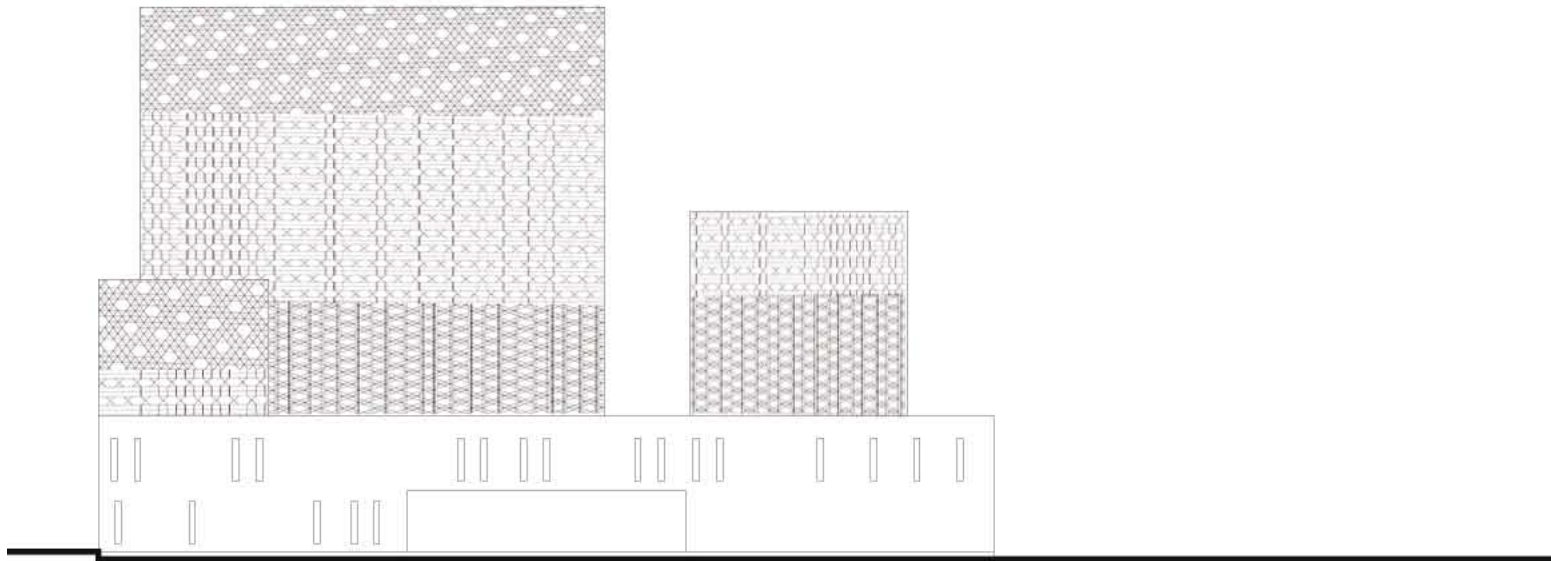

ELEVATION TOWARD RESORT



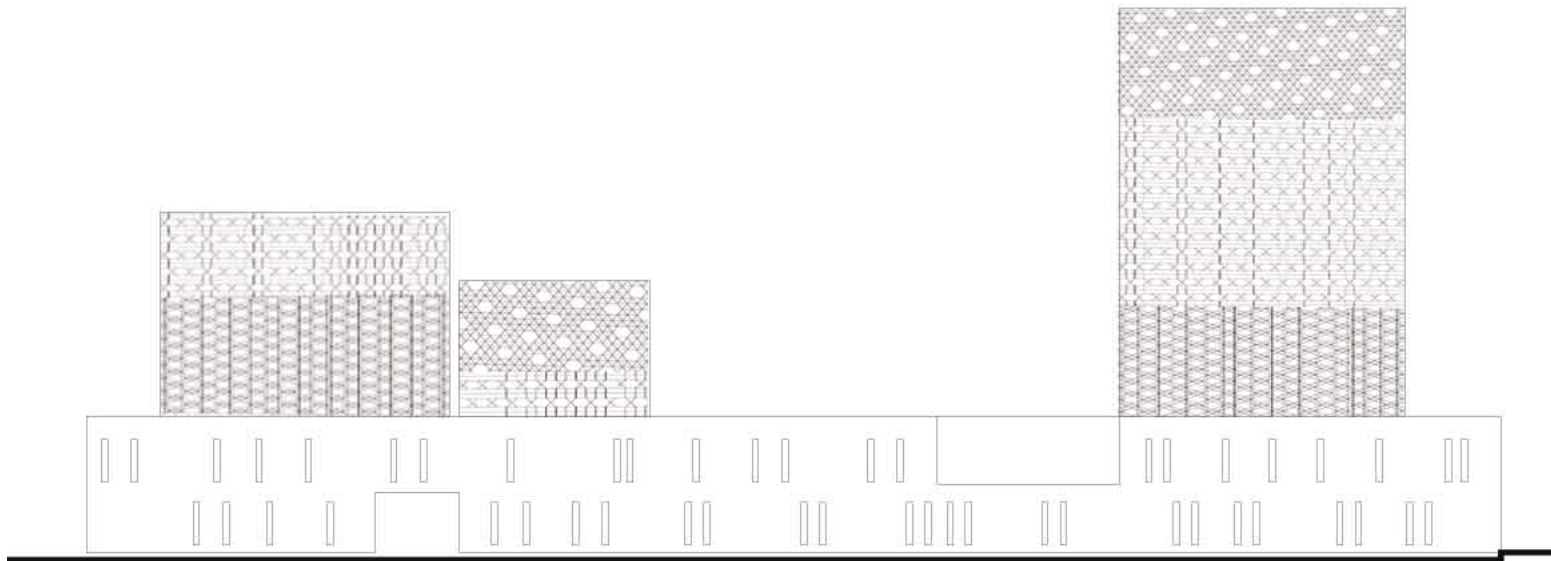

BACK ELEVATION

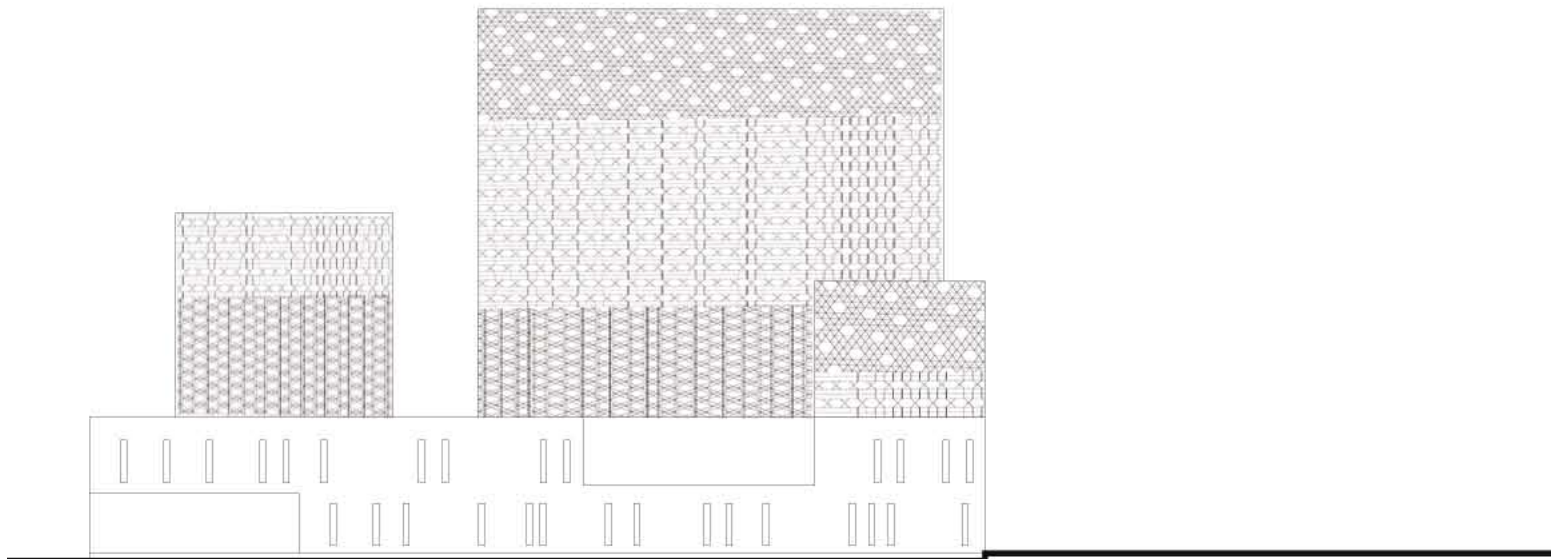

ELEVATION TOWARD CAMPUS

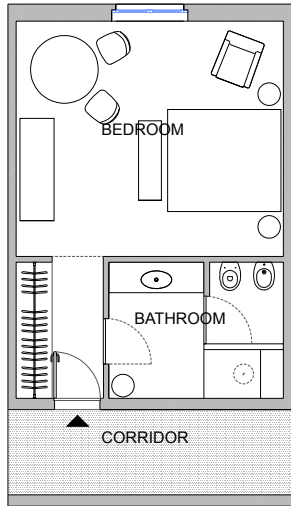

**STANDARD**  
(KING SIZE)  
32 sqm

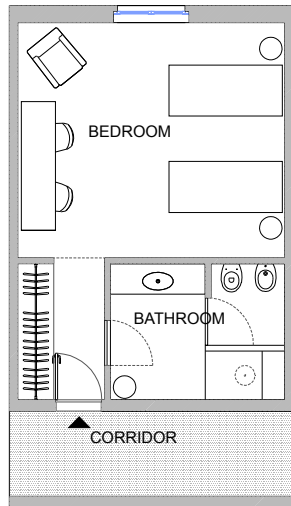

**STANDARD**  
(DOUBLE DOUBLE)  
32 sqm

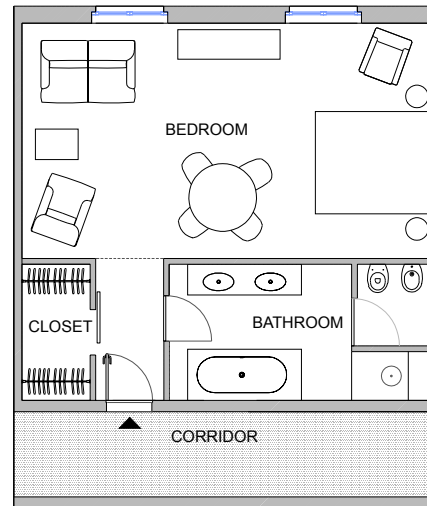

**SUITE**  
48 sqm

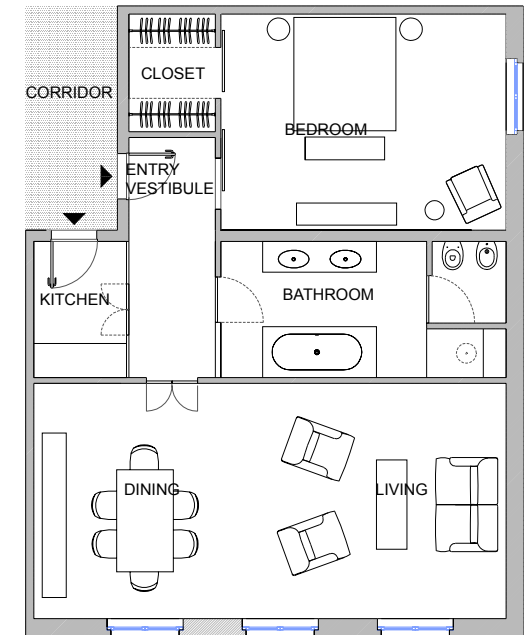

**CLUB SUITE**  
82 sqm







Dear Sir, if you wish to have the entire dossier just go on the web-site where you will find the link where you will have to compile the contact form.